



DATA SHEET

1/9/2012

Page 1 / 3

Receiver

From

Society
Reference
Address
Telephone
Fax
E-mail

Item no. 103022414

Pump data :

Model :
NOVA 600 M-A
Pressure rating :
Min. fluid temperature : 0 °C
Max. fluid temperature : 35 °C
Max. Temperature operating : 40 °C

Requested data :

Flow 0 m³/h
Head 0 m
Fluid : Water, pure
Fluid Temperature : 20 °C
Density : 998.3 kg/m³
Kinematic viscosity 1.005 mm²/s
Vapor pressure : 100 kPa

Hydraulic data (duty point)

Flow
Head

Materials :

Pump body	Technopolymer
Impeller	Technopolymer
OR ring	Rubber NBR
Motor top body	AISI 304 X5 Cr Ni 1810 UNI 6900/71
Rotor shaft	AISI 416 X12 CrS 13 UNI 6900/71
Seeger ring	12E - UNI 7435 STAINLESS
Wearing disc (Only for NOVA)	Technopolymer

Curve tolerance according to ISO 9906

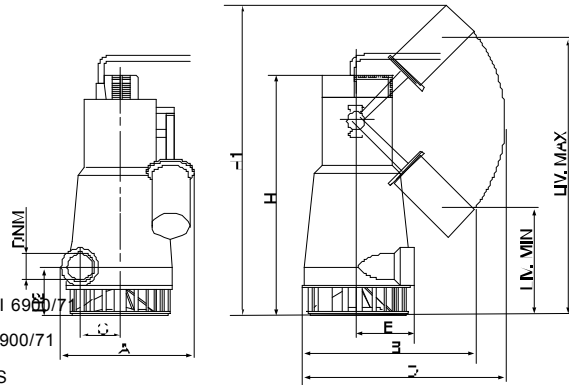
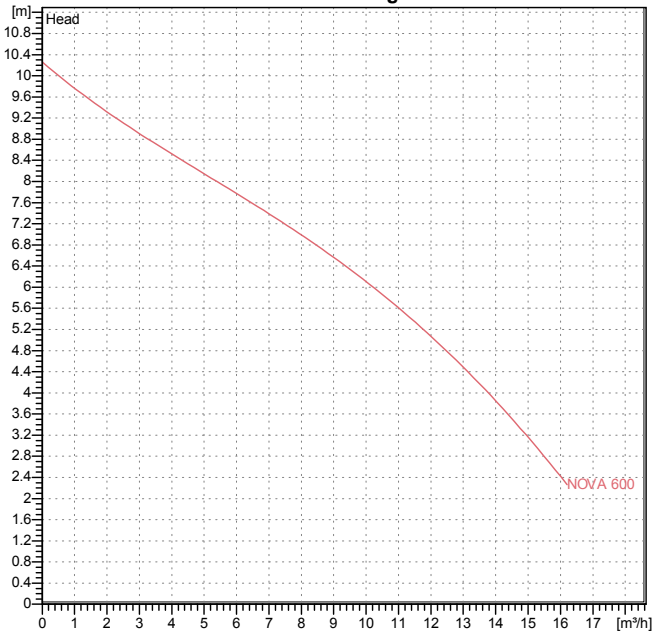

Motor data :

Weight : 7 kg

Trade mark : DAB
Nominal power P2: 0.55 kW
Rated speed: 2850 1/min
Rated voltage : 1~ 0 V 50 Hz
Nominal current : 0 A
Degree of protection : IP 68

Dimension

mm

A	193	H1	443		
B	235	H2	73		
C	56	LIV MAX	390		
D	296	LIV MIN	190		
DNM	1"1/4 G				
E	90				
H	368				

Pump connection

Suction side /
Discharge side 1 " 1/4 G' --



PERFORMANCE CURVES

1/9/2012

Page 2 / 3

Receiver

From

Society
Reference
Address
Telephone
Fax
E-mail

NOVA 600 M-A

Curve tolerance according to ISO 9906

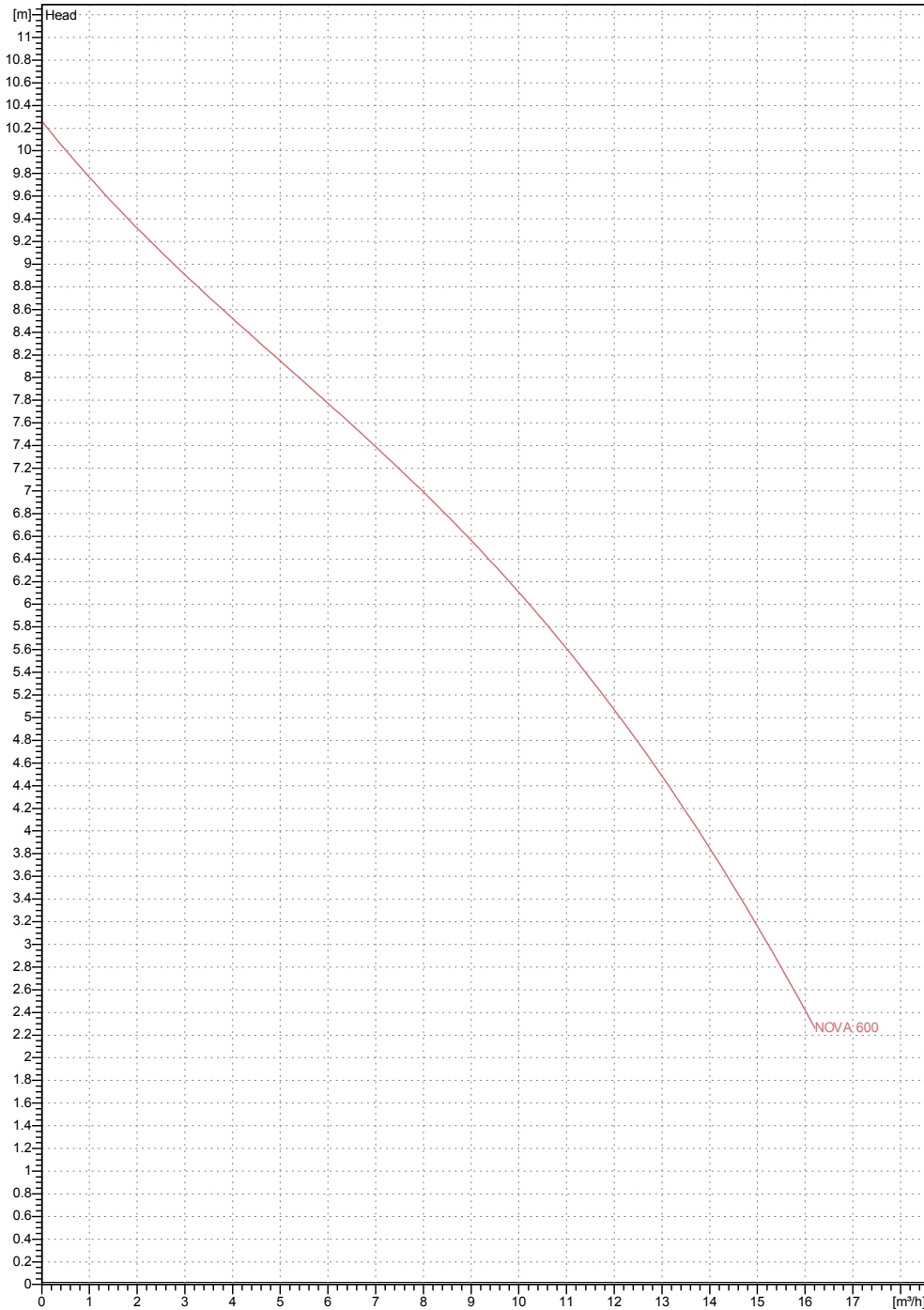

Hydraulic data (duty point)

Suction side /	Discharge side 1" 1/4" G	Flow 0 m³/h	Head 0 m	Speed 2850 1/min
Project	Project ID	Created by	Created on 1/9/2012	



DIMENSIONAL DRAWING

1/9/2012

Page 3 / 3

Receiver

From

Society
Reference
Address
Telephone
Fax
E-mail

NOVA 600 M-A

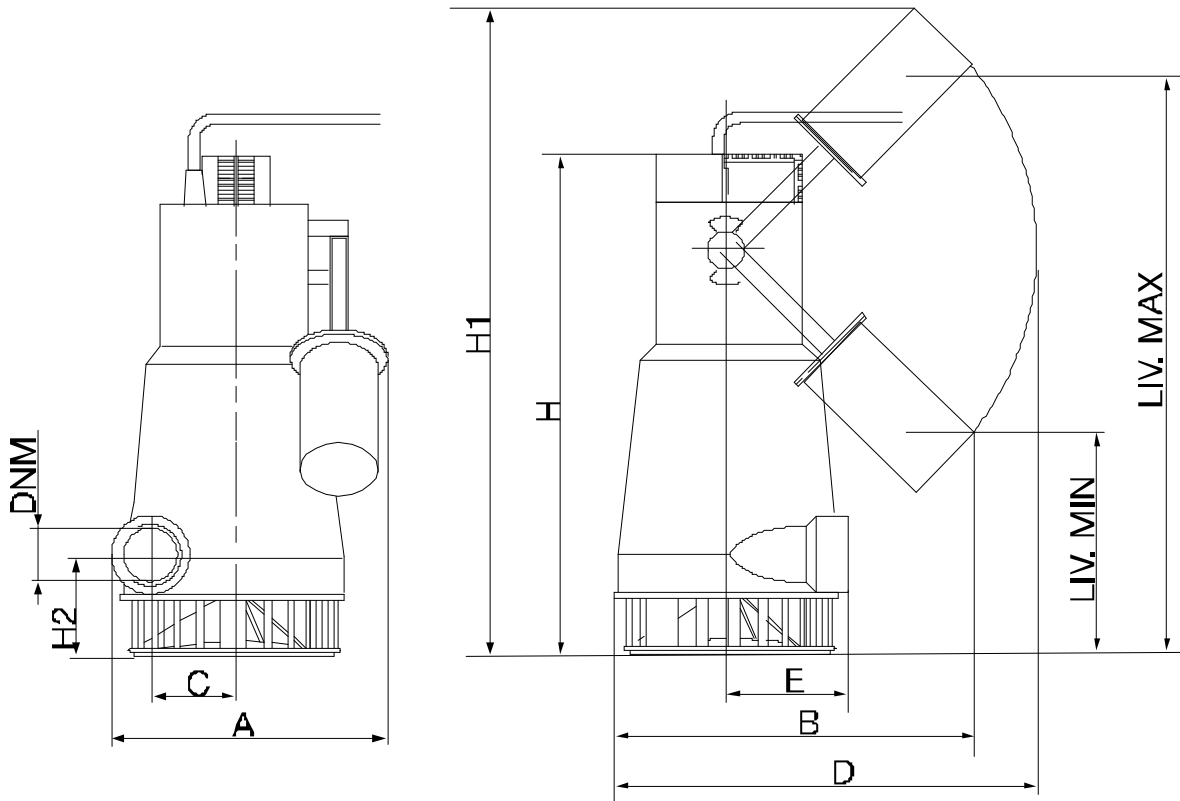

Dimensions in mm										Pump connection
1	A	193	LIV MIN	190						Suction
2	B	235								
3	C	56								
4	D	296								Discharge 1 " 1/4 G
5	DNM	1"1/4 G								
6	E	90								--
7	H	368								
8	H1	443								
9	H2	73								
10	LIV MAX	390								
Project			Project ID			Created by			Created on 1/9/2012	